



# ASPIRE

— TO MOVE —



## Dahlia Gardens, Bath, BA2

STUDENTS ACCEPTED. Two double bedroom, furnished apartment overlooking Sydney Gardens, with parking and a garage. Available 11th July.

Dahlia Gardens is located 0.2 miles from Great Pulteney Street, overlooking Sydney Gardens, and offers a level walk into Bath city centre which is 0.4 miles away.

**£1,950 PCM**

# Dahlia Gardens, Bath, BA2

- Students accepted
- Communal gardens
- Assured Periodic Tenancy
- Two bedroom flat
- Furnished
- Holding deposit: £450
- Council tax band D if applicable
- Available 11th July
- Parking and garage

STUDENTS ACCEPTED. Two double bedroom, furnished apartment overlooking Sydney Gardens, with parking and a garage. Available 11th July.

Dahlia Gardens is located 0.2 miles from Great Pulteney Street, overlooking Sydney Gardens, and offers a level walk into Bath city centre which is 0.4 miles away.

The apartment is located on the first floor with views over Sydney Gardens. The living/dining area is open-plan, with double windows allowing plenty of natural light. Two sofas and dining table with chairs are provided. There is a modern kitchen which has base and wall units, cooker, hob, extractor, fridge/freezer, integrated dishwasher, washer/dryer, and gas combi-boiler.

There are two double bedrooms, both of which have double beds, wardrobe storage, chest of drawers and bedside tables. The shower room has a walk-in shower, sink with storage, and WC. There is a hallway storage cupboard. The property benefits from communal parking space, gardens, a private garage. The flat also has access to a communal roof aerial for Sky / Free Sat / terrestrial TV.

Available 11th July, the flat is offered furnished and would best suit a two students.

Council tax band D if applicable: £2325.27

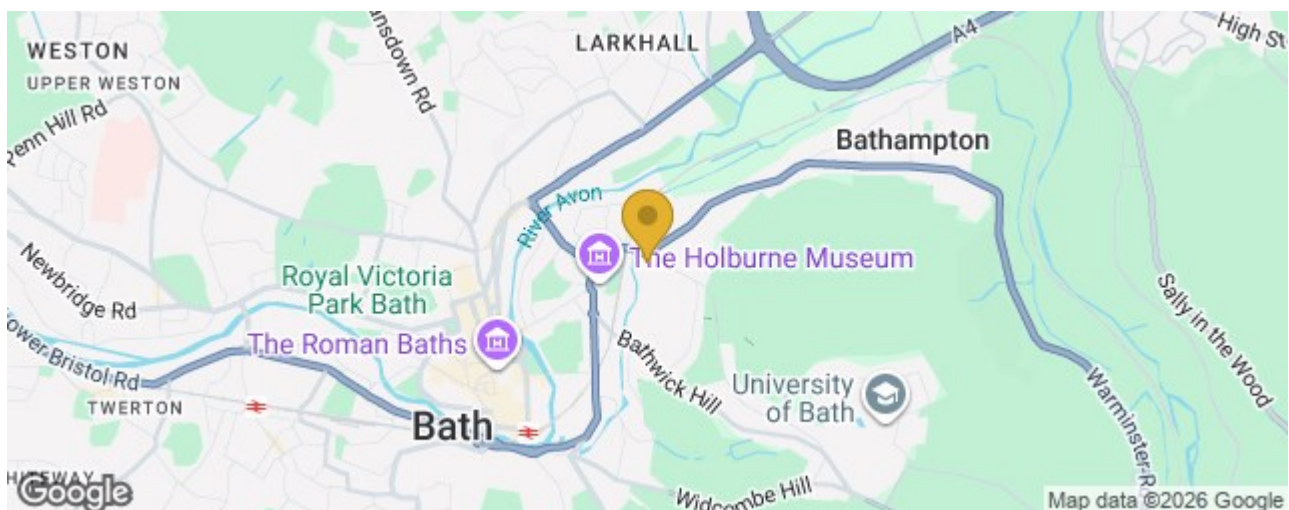



FIRST FLOOR  
713 sq.ft. (66.2 sq.m.) approx.

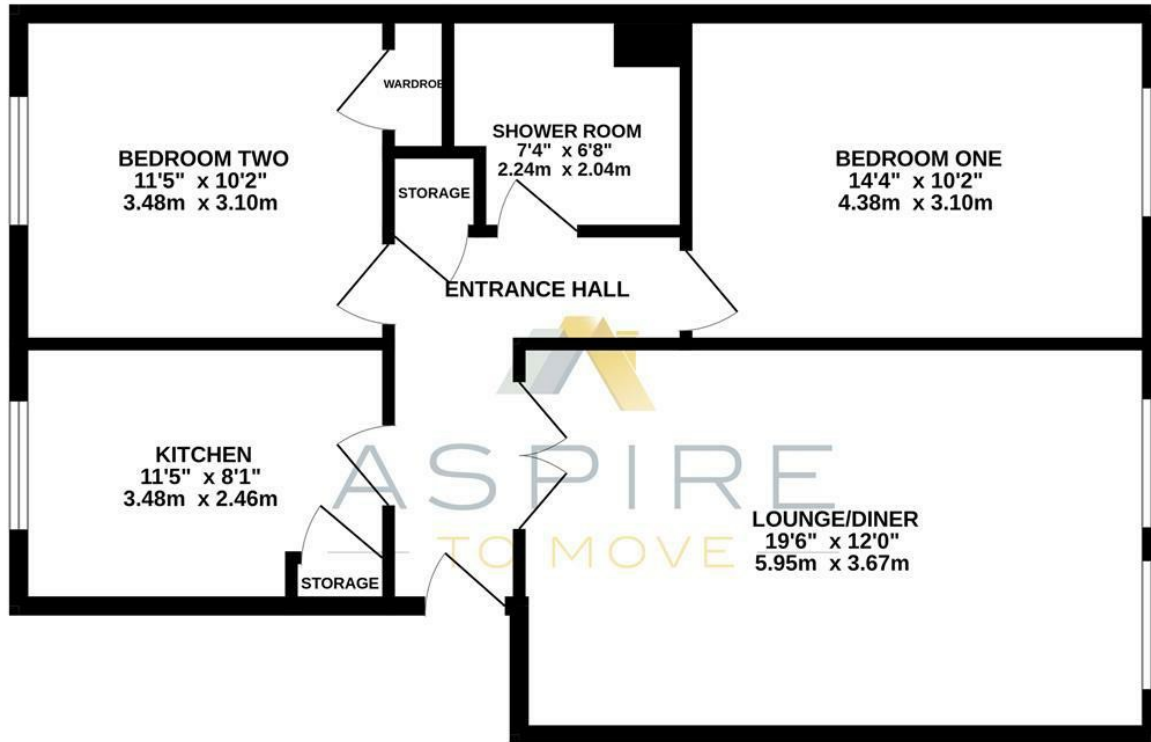

DAHLIA GARDENS, BATH, BA2

TOTAL FLOOR AREA: 713 sq.ft. (66.2 sq.m.) approx.

Whilst every attempt has been made to ensure the accuracy of the floorplan contained here, measurements of doors, windows, rooms and any other items are approximate and no responsibility is taken for any error, omission or mis-statement. This plan is for illustrative purposes only and should be used as such by any prospective purchaser. The services, systems and appliances shown have not been tested and no guarantee as to their operability or efficiency can be given.  
Made with Metropix ©2025

These particulars, whilst believed to be accurate are set out as a general outline only for guidance and do not constitute any part of an offer or contract. Intending purchasers should not rely on them as statements of representation of fact, but must satisfy themselves by inspection or otherwise as to their accuracy. No person in this firm's employment has the authority to make or give any representation or warranty in respect of the property.

